

Pro-Cast & Pro-Lite Split Fiberglass Columns



INSTALLATION INSTRUCTIONS

Notes:
 -SPLIT COLUMNS ARE NOT LOAD BEARING.
 -Reassembly Split Kit REKIT01 includes everything needed to reassemble a split column.
 -AFCO Industries, Inc. offers an optional TAB feature – TABS400 to aid in the reassembly of the Pro-Lite series columns.

1. To avoid a mismatch during reassembly, number both halves of each column as they are unpackaged.
Note: Pro-Cast columns are designed with perforations to protect the column during transit.

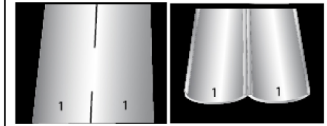

2. For highest bond strength, wipe down mating column surfaces with acetone or naphtha to ensure complete removal of debris.



3. Apply FRP Adhesive to all connecting surfaces on both halves. FRP Adhesive can be used between 50°F (10°C) and 90°F (32°C). Cure time increases with lower temperatures.



4. Align the halves around the structural support and bring completely together. Secure using straps along the length of the column and pull tight.

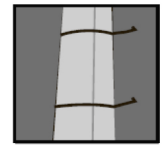

5. Pre-drill and install the aluminum plates provided in split kit to the top and bottom of each seam.

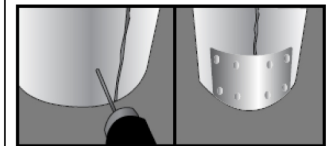

6. Allow a minimum of 24 to 72 hours for FRP Adhesive to cure.

7. Cut away the straps and remove any excess adhesive by cutting, scraping or sanding with a dustless sander.



8. Smooth auto body filler over seam and sand for a professional finish.

9. Follow the same procedure for the capital and base.

Finishing instructions: Prepare the column, capital and base for painting by sanding with 100 grit sandpaper or a sanding sponge. Follow the paint manufacturer's instructions for proper surface preparation. Paint with high quality latex or oil based paint.

PRO-CAST & PRO-LITE SPLIT FIBERGLASS COLUMNS