

# 125 Series AFCO-Rail Level Rail



## INSTALLATION INSTRUCTIONS



**AFCO**  
Columns and Railings  
a Division of AFCO Industries, Inc.

The instructions listed on these pages to assemble the 125 Series Level Rail will replace steps 3 & 4 on the 100 Level Rail Installation Instructions.

### PARTS INCLUDED:

LEVEL INTERMEDIATE RAIL WITH CONNECTORS (1) - Style "D" shown below

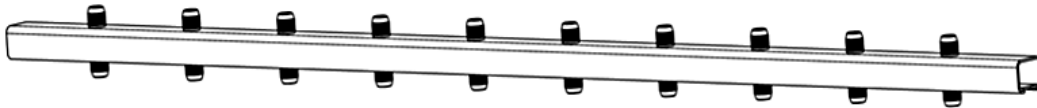

BOTTOM BRACKET (1)

#10x1" SELF DRILLING SCREWS (4)

4" BALUSTERS (QTY PACKED AS REQUIRED)

25-9/16" OR 31-9/16" BALUSTERS (QTY PACKED AS REQUIRED)

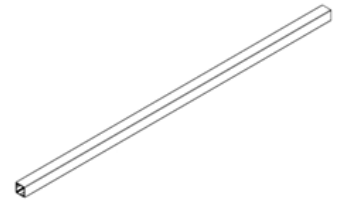
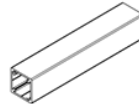
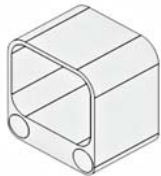

### TOOLS REQUIRED:

Miter Saw (with metal cutting blade)  
Rubber mallet  
Tape measure  
Touch-up paint

### NOTES:

- Post not included (packaged separately)
- Balusters are included in the package based on order requirements.
- An AFCO-Tool is available to simplify the locating, pre-drilling and installation of brackets.

### FOR A SUCCESSFUL INSTALLATION:

- Read the instructions completely before beginning the installation.
- Plan your railing project. Sketch your project with the actual measurements of your deck or balcony complete with post locations.
- Check local building codes to ensure compliance.
- Check carton(s) to determine part count is complete.
- After cutting rails, balusters, or posts, paint exposed metal for maximum protection against the elements.
- Installation is best accomplished with two people.
- Wear personal protection equipment; safety glasses, etc.
- Use care not to over-torque the screws. Pre-drilling is recommended.
- **Provided hardware to install AFCO-Rail is for use with Aluminum AFCO-Rail posts. If installing to other surfaces the installer must acquire the appropriate hardware as needed for proper installation.**

125 SERIES AFCO-RAIL LEVEL RAIL

1. Carefully measure and cut (if required) the Intermediate Rail to the same length as the Bottom Rail (B) from the 100 Series Level Rail Kit.

2. Align the baluster connectors in the Top Rail (A) from the Level Rail kit, with the baluster connectors in the smooth (top side) of the Intermediate Rail.

3. Using the driver bit tip included in the 100 Series Level Rail Kit, remove the baluster connectors from the Top Rail (A) that corresponds with the spaces in the Intermediate Rail.  
*Note: Omit this step if Style "D" is being installed. All connectors are required.*

4. To assemble rail, begin with Top Rail (A) and insert 4" balusters over pre-installed connectors. Firmly tap each baluster with a rubber mallet to ensure the baluster is fully seated against the Top Rail.  
*Note: It is recommended to use the box as a pad to prevent scuffing of the painted finish. If installing square balusters, make sure they are seated in the slot on the underside of the Top Rail to prevent twisting.*

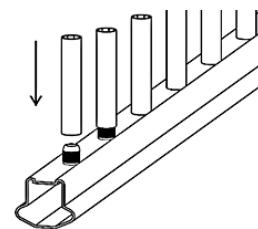

5. Place the Intermediate Rail with top side (smooth) facing towards the Top Rail (A) and align all baluster connectors with the 4" balusters installed in the Top Rail (A). Stand the assembly upside down on the surface of the box and firmly tap the Intermediate Rail with a rubber mallet to secure the balusters in place.

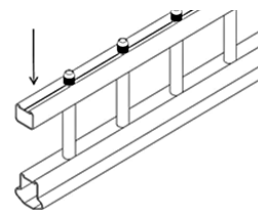

6. Place all required longer balusters over the pre-installed baluster connectors in the bottom (grooved side) of the Intermediate Rail and firmly tap each one in place.  
*Note: If installing square balusters, make sure they are seated in the slot on the underside of the Intermediate Rail to prevent twisting.*

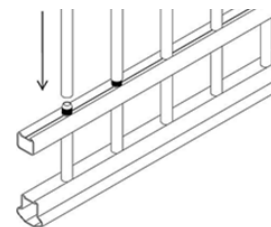

7. Align the baluster connectors on the Bottom Rail (B) from the 100 Series Level Rail kit, with the longer balusters installed in step 6. Starting at one end and working towards the opposite end firmly tap the bottom rail with a rubber mallet to secure the balusters in place. Stand assembly upright.

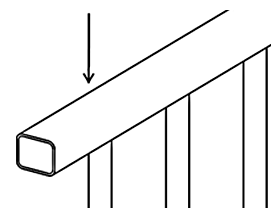

8. Slide Bottom Brackets included in the 125 Series kit onto each end of the Intermediate Rail with counter bore holes facing down and towards the balusters.  
*Note: Brackets will be installed and secured later in step 12 of the 100 Series Level Rail Instruction.*